

Product features

- Torque range Md = 10-100 Nm
- Limit switches 4 adjustable limit switches 5A (2x int. + 2x ext.)
- Duty rating ED = 50%
- Temperature range -10°C ÷ 55°C



Construction

1	Position indicator
2	Cover ABS
3	Stainless steel screws (4x)
4	Auxiliary limit switch terminal trip
5	Circuit board
6	Gear box plate
7	Reductor
8	Connector (3P+T)
9	Gland PG. M20
10	Housing
11	Cams (4x)
12	Motor
13	Clutch knob
14	Spring

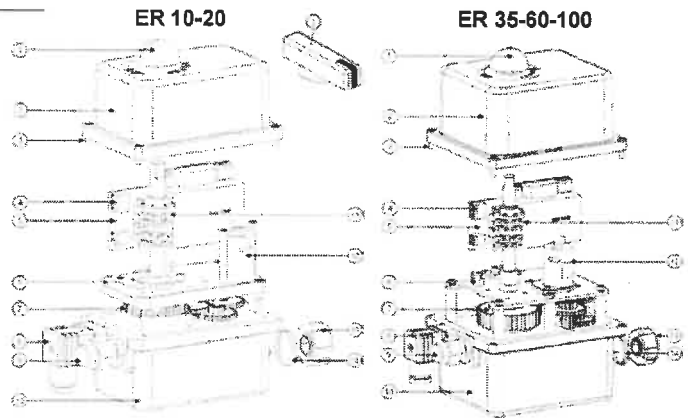

Emergency manual override:

- In case of an electric supply failure, it is possible to operate the actuator manually:
- Turn the clutch knob «13» to position MAN and hold it in position (reduction «7» disengaged)
 - Turn the outgoing drive shaft of the actuator with the handlever (ER10-20) or a adjusting spanner (ER35-100).
 - In order to re-engage the reduction, release the clutch knob.



Dimensions

	L	B	H	K	ISO 5211	[kg]
ER10	136	90	124	45	F03-F04-F05	1,5
ER20	136	90	124	45	F03-F04-F05	1,5
ER35	151	127	152	54	F05-F07	3,0
ER60	151	127	152	54	F05-F07	3,0
ER100	151	127	152	54	F05-F07	3,0

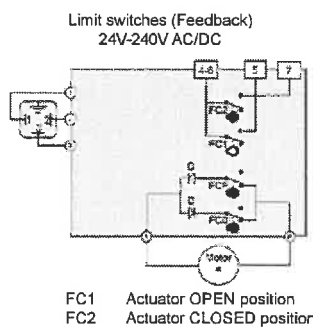
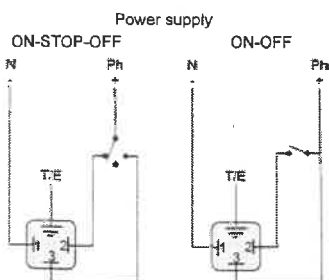
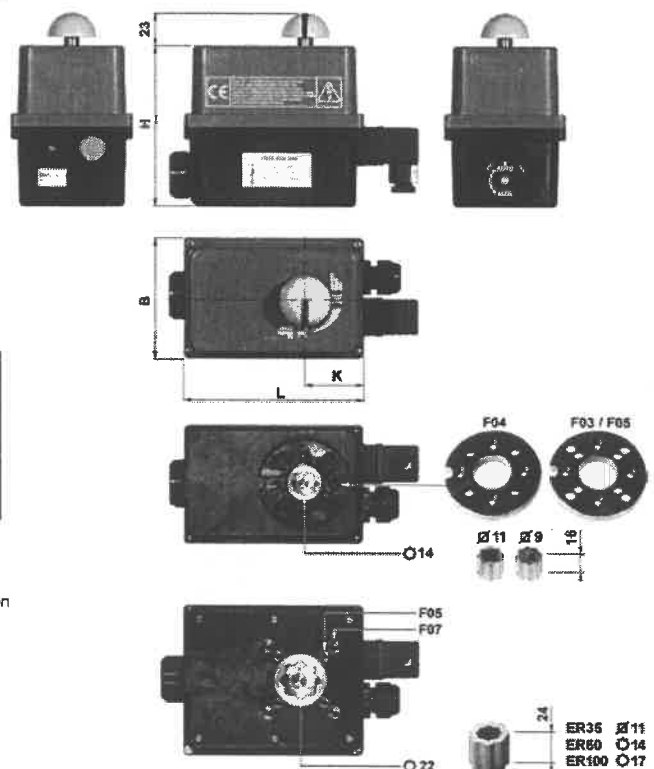

Fluids under control.

Executions

Multivolt (Standard)

Type	Code	ISO 5211	Shaft	Shaft reduction*	Torque	Voltage	ON-OFF	Power
ER10-100-240/AC-010-F03-F04-F0514	ER10.X3A.S00	F03-F04-F05	*14	□11 □9	10 Nm	100-240V, 50/60Hz	10 s	15 W
ER10-24/ACDC-010-F03-F04-F0514	ER10.X33.S00	F03-F04-F05	*14	□11 □9	10 Nm	24V AC/DC	10 s	15 W
ER20-100-240/AC-020-F03-F04-F0514	ER20.X3A.S00	F03-F04-F05	*14	□11 □9	20 Nm	100-240V, 50/60Hz	20 s	15 W
ER20-24/ACDC-020-F03-F04-F0514	ER20.X33.S00	F03-F04-F05	*14	□11 □9	20 Nm	24V AC/DC	20 s	15 W
ER35-100-240/AC-035-F05-F0722(11)	ER35.93A.S00	F05-F07	*22	*17 *14 □11	35 Nm	100-240V, 50/60Hz	35 s	15 W
ER35-24/ACDC-035-F05-F0722(11)	ER35.933.S00	F05-F07	*22	*17 *14 □11	35 Nm	24V AC/DC	35 s	15 W
ER60-100-240/AC-060-F05-F0722(14)	ER60.93A.S00	F05-F07	*22	*17 *14 □11	60 Nm	100-240V, 50/60Hz	60 s	15 W
ER60-24/ACDC-060-F05-F0722(14)	ER60.933.S00	F05-F07	*22	*17 *14 □11	60 Nm	24V AC/DC	60 s	15 W
ER100-100-240/AC-100-F05-F0722(17)	ER100.93A.S00	F05-F07	*22	*17 *14 □11	100 Nm	100-240V, 50/60Hz	100 s	15 W
ER100-24/ACDC-100-F05-F0722(17)	ER100.933.S00	F05-F07	*22	*17 *14 □11	100 Nm	24V AC/DC	100 s	15 W

Failsafe (SS1, SS2): Closing of actuator in case of electric supply failure. ER10-20 with electrical condenser, ER35-100 with battery

Type	Code	ISO 5211	Shaft	Shaft reduction*	Torque	Voltage	ON-OFF	Power
ER10-100-240/AC-010-F03-F04-F0514-SS1	ER10.X3A.S01	F03-F04-F05	*14	□11 □9	10 Nm	100-240V, 50/60Hz	10 s	15 W
ER10-24/ACDC-010-F03-F04-F0514-SS1	ER10.X33.S01	F03-F04-F05	*14	□11 □9	10 Nm	24V AC/DC	10 s	15 W
ER20-100-240/AC-020-F03-F04-F0514-SS1	ER20.X3A.S01	F03-F04-F05	*14	□11 □9	20 Nm	100-240V, 50/60Hz	20 s	15 W
ER20-24/ACDC-020-F03-F04-F0514-SS1	ER20.X33.S01	F03-F04-F05	*14	□11 □9	20 Nm	24V AC/DC	20 s	15 W
ER35-100-240/AC-035-F05-F0722(11)-SS2	ER35.93A.S02	F05-F07	*22	*17 *14 □11	35 Nm	100-240V, 50/60Hz	35 s	15 W
ER35-24/ACDC-035-F05-F0722(11)-SS2	ER35.933.S02	F05-F07	*22	*17 *14 □11	35 Nm	24V AC/DC	35 s	15 W
ER60-100-240/AC-060-F05-F0722(14)-SS2	ER60.93A.S02	F05-F07	*22	*17 *14 □11	60 Nm	100-240V, 50/60Hz	60 s	15 W
ER60-24/ACDC-060-F05-F0722(14)-SS2	ER60.933.S02	F05-F07	*22	*17 *14 □11	60 Nm	24V AC/DC	60 s	15 W
ER100-100-240/AC-100-F05-F0722(17)-SS2	ER100.93A.S02	F05-F07	*22	*17 *14 □11	100 Nm	100-240V, 50/60Hz	100 s	15 W
ER100-24/ACDC-100-F05-F0722(17)-SS2	ER100.933.S02	F05-F07	*22	*17 *14 □11	100 Nm	24V AC/DC	100 s	15 W

With Positioner (SP6): 4-20mA / 0-10V

Type	Code	ISO 5211	Shaft	Shaft reduction*	Torque	Voltage	ON-OFF	Power
ER20-100-240/AC-020-F03-F04-F0514-SP6	ER20.X3A.SP6	F03-F04-F05	*14	□11 □9	20 Nm	100-240V, 50/60Hz	20 s	15 W
ER20-24/ACDC-020-F03-F04-F0514-SP6	ER20.X33.SP6	F03-F04-F05	*14	□11 □9	20 Nm	24V AC/DC	20 s	15 W
ER35-100-240/AC-035-F05-F0722(11)-SP6	ER35.93A.SP6	F05-F07	*22	*17 *14 □11	35 Nm	100-240V, 50/60Hz	35 s	15 W
ER35-24/ACDC-035-F05-F0722(11)-SP6	ER35.933.SP6	F05-F07	*22	*17 *14 □11	35 Nm	24V AC/DC	35 s	15 W
ER60-100-240/AC-060-F05-F0722(14)-SP6	ER60.93A.SP6	F05-F07	*22	*17 *14 □11	60 Nm	100-240V, 50/60Hz	60 s	15 W
ER60-24/ACDC-060-F05-F0722(14)-SP6	ER60.933.SP6	F05-F07	*22	*17 *14 □11	60 Nm	24V AC/DC	60 s	15 W
ER100-100-240/AC-100-F05-F0722(17)-SP6	ER100.93A.SP6	F05-F07	*22	*17 *14 □11	100 Nm	100-240V, 50/60Hz	100 s	15 W
ER100-24/ACDC-100-F05-F0722(17)-SP6	ER100.933.SP6	F05-F07	*22	*17 *14 □11	100 Nm	24V AC/DC	100 s	15 W

Additional equipment:

Type	for actuator ->	ER-Standard	ER-Failsafe (SS1, SS2)	ER-Positioner (SP6)
EPR.1B	Potentiometer 1000 Ohm			
EPR.5B	Potentiometer 5000 Ohm	✓	-	-
EPR.10B	Potentiometer 10000 Ohm			
EFC.2	2 additional limit switches	✓	-	-
ERT.B	Heating resistor 10W automatic 35-50°C	✓	-	-
ERI.P6	Heating resistor 10W regulated	-	-	✓

* Shaft reduction (grey values) optional available:

Type	
PSA.22/11	*22 / □11
PSS.22/14	*22 / *14
PSS.22/17	*22 / *17



<p>InterApp AG Grundstrasse 24 CH-6343 Rotkreuz Phone +41 (0) 41 7982233 Fax +41 (0) 41 7982234 info@ch.interapp.net</p>	<p>InterApp Germany Im Wasen 2 D-78667 Villingendorf (RW) Phone +49 (0) 741 34855290 Fax +49 (0) 741 34855292 info@de.interapp.net</p>	<p>InterApp Austria Kolpingstrasse 19 A-1230 Wien Phone +43 (0) 1 6162371-0 Fax +43 (0) 1 6162371-99 info@at.interapp.net</p>	<p>InterApp Italy Via Gramsci 29 I-20016 Pero (MI) Phone +39 02 339371 Fax +39 02 33937290 info@it.interapp.net</p>	<p>InterApp Spain Calderón de la Barca 12 E-28860 Paracuellos de Jarama Phone +34 (0) 91 6584360 Fax +34 (0) 91 6581430 info@es.interapp.net</p>	<p>InterApp France La Picoterie F-14400 Arganchy Phone +33 (0) 67 4366134 Fax +33 (0) 23 1211895 info@fr.interapp.net</p>	<p>InterApp Singapore Pte. Ltd. 11, Changi North Street 1, #03-11 Singapore 496823 Phone +65 62141048 Fax +65 62140461 info@sg.interapp.net</p>
--	--	---	---	--	---	---

The technical data are noncommittal and do not assure you of any properties. Please refer to our general sales conditions. Modifications without notice.
© 2009 InterApp AG, all rights reserved