

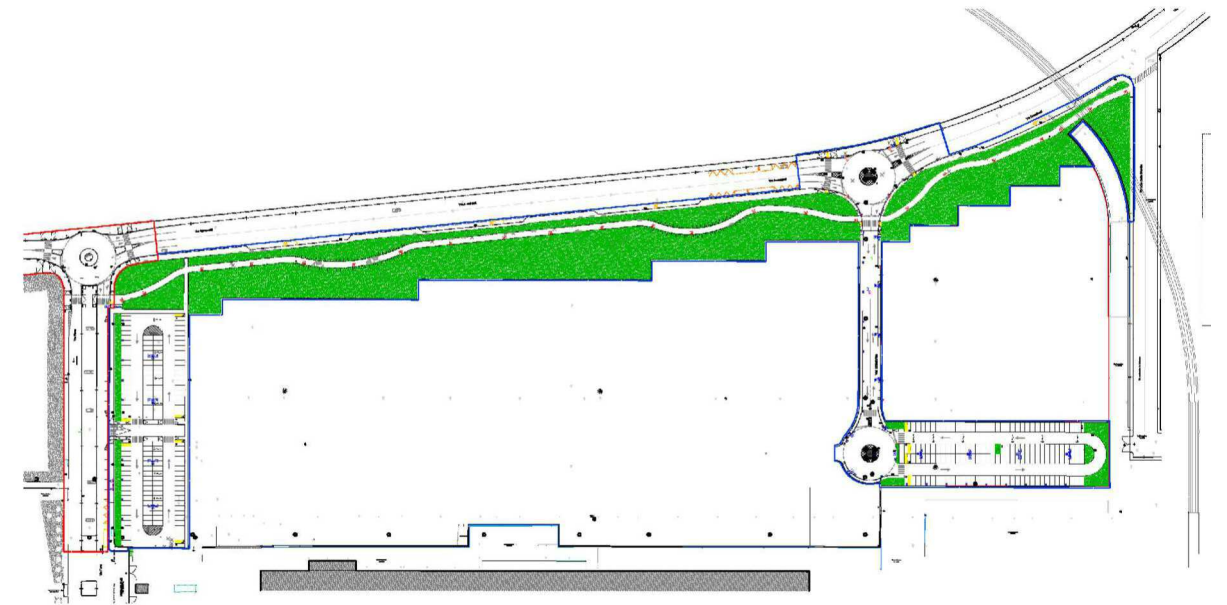

CITTA' DI TORINO

## TORINO NUOVA ECONOMIA S.P.A.

RIQUALIFICAZIONE ZONA "C" - AREA MIRAFIORI  
ZONA URBANA CONSOLIDATA PER ATTIVITÀ PRODUTTIVE (IN)



### PIANO ESECUTIVO CONVENZIONATO

(artt. 43 e 45 della L.U.R.)

### E01 - PROGETTO URBANISTICO

Elaborato

E01 c) *Elaborati grafici*

Proprietà:



Torino Nuova Economia S.p.A.  
Via Livorno, 60 - 10144 Torino

c/o Environment Park Palazzina B2 Uffici

Progettisti:

CAPOGRUPPO MANDATARIA:  
ICIS - SOCIETÀ DI INGEGNERIA s.r.l.  
C.so Einaudi, 8 - 10128 TORINO  
Tel. 011 5683633 Fax 011 503358  
D.T. Ing. Silvano CROSAZZO

MANDANTI:  
- SI.ME.TE s.r.l., Prof. Ing. Giorgio Nicola SINISCALCO  
- M.C.M. s.r.l., Per. Ind. Angelo DI CARLO  
- STUDIO A.T.A., Arch. Alberto ROSSO  
- Ing. Giovanni BEE  
- Dott. Agr. Dario GRUA

MARZO 2015

AREA OGGETTO DI PEC					
Foglio	Particella	Sub	Porz	Qualità Classe	Superficie(m <sup>2</sup> ) ha are ca
1436	93		-	Ente urbano	04 64 11
1436	94		-	Ente urbano	01 27 70
1436	95		-	Ente urbano	00 00 28
1436	96		-	Ente urbano	00 05 49
1436	97		-	Ente urbano	00 43 40
1436	98		-	Ente urbano	01 00 64
1436	99		-	Ente urbano	00 34 95
1436	100		-	Ente urbano	00 33 49
1436	101		-	Ente urbano	00 18 82
				<b>TOT</b>	<b>08 28 88</b>

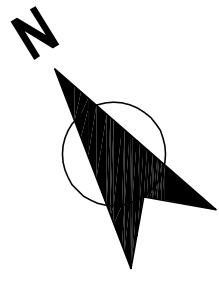



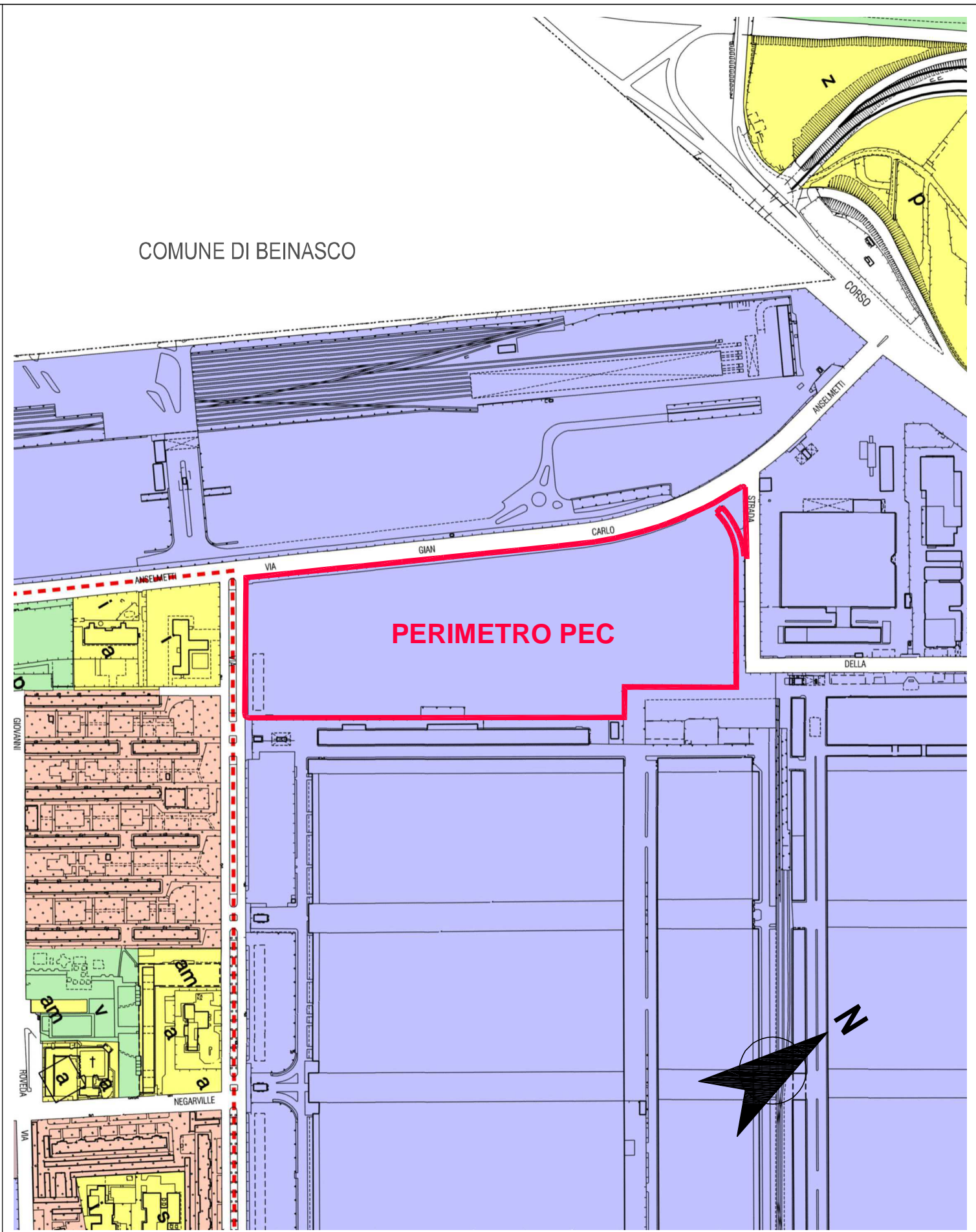
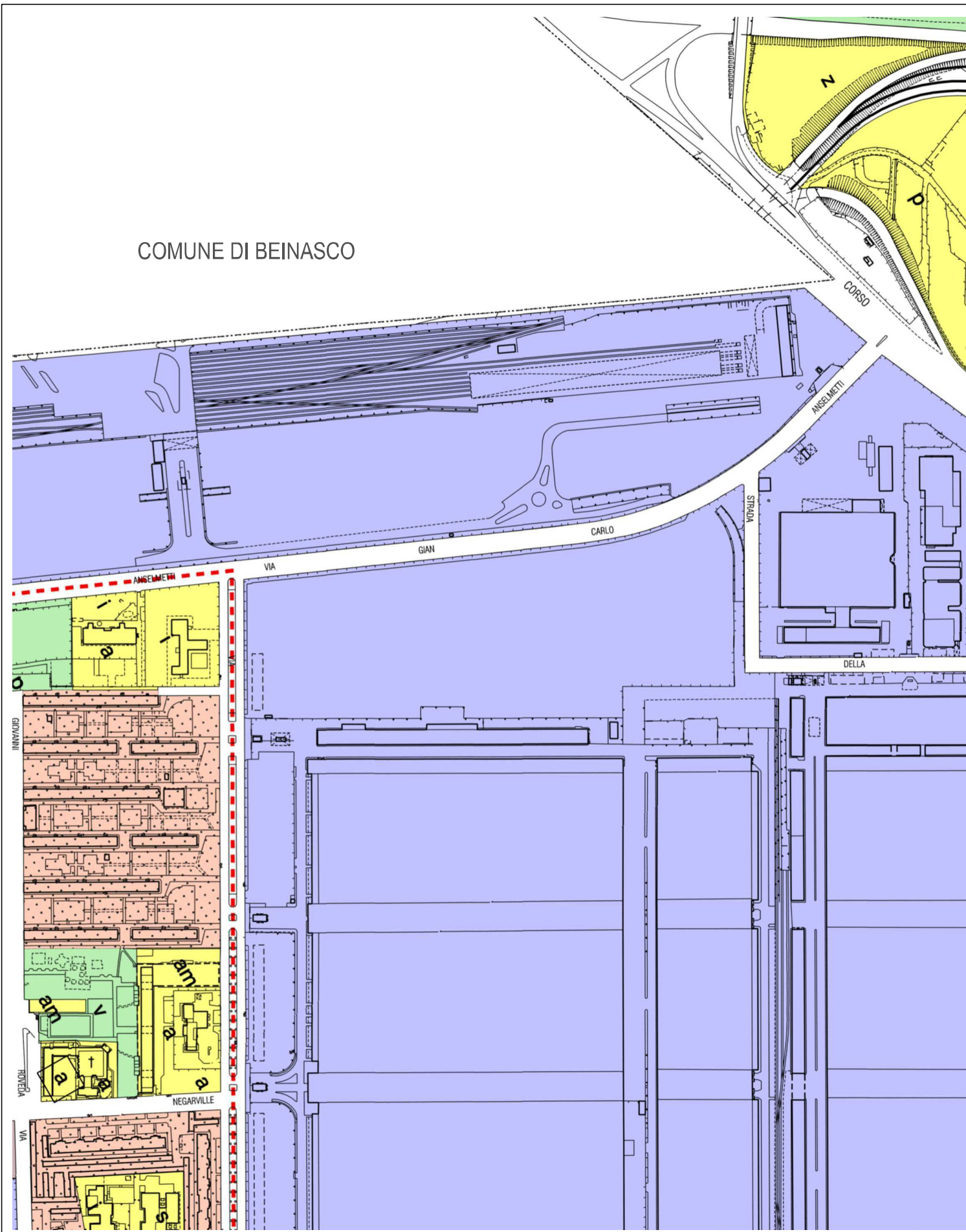



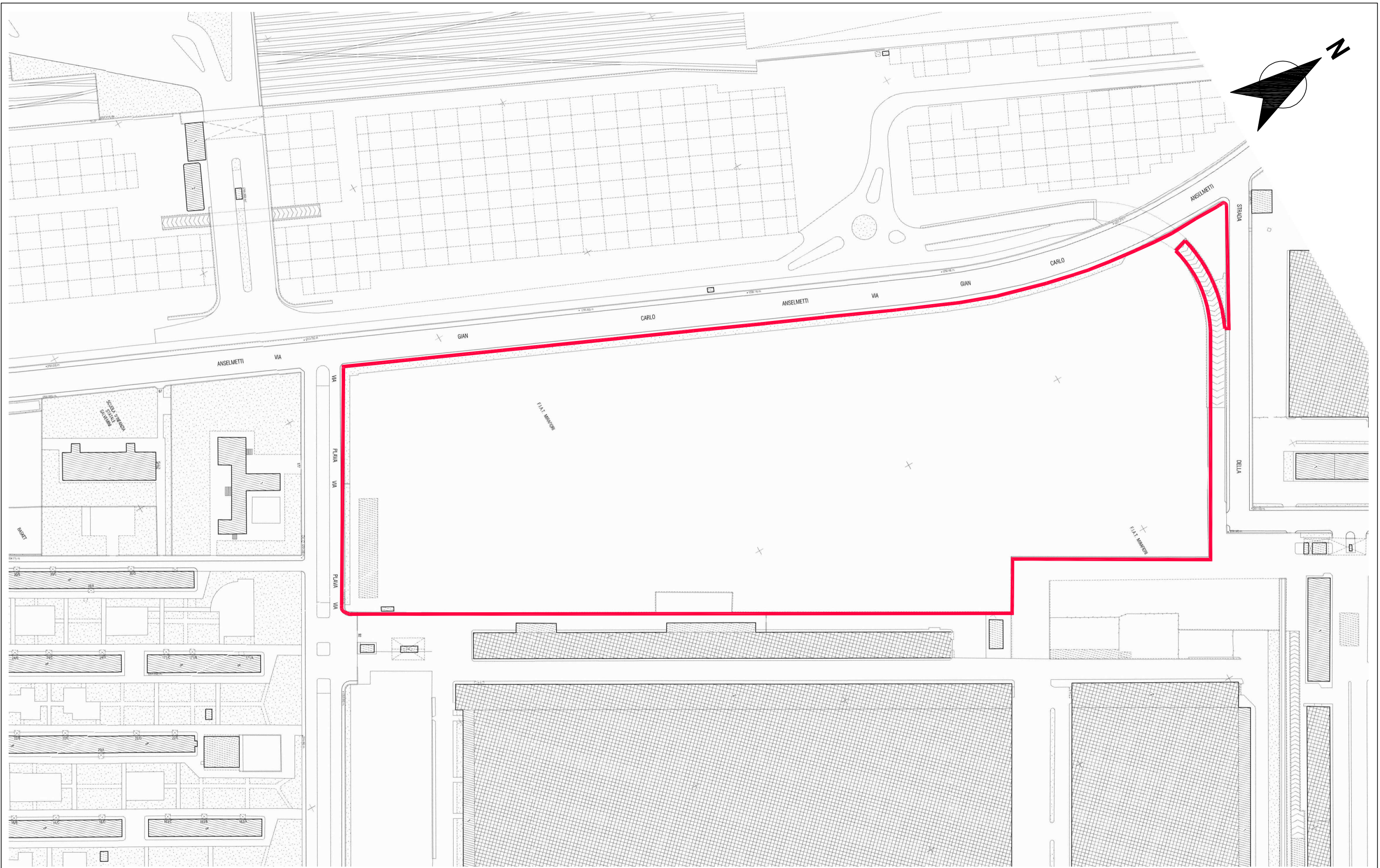









Fotografia aerea



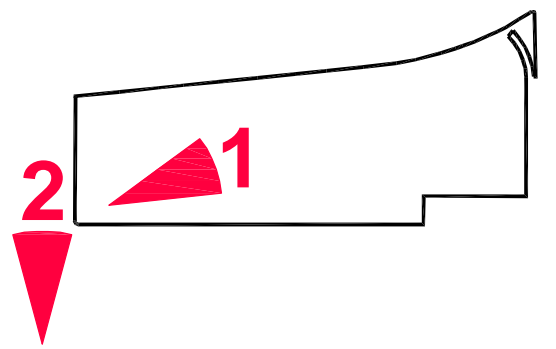





Cavo MT 3 KV



Rete antincendio interrata



Sottopasso ferroviario



Sottopasso mezzi gommati



Piezometri

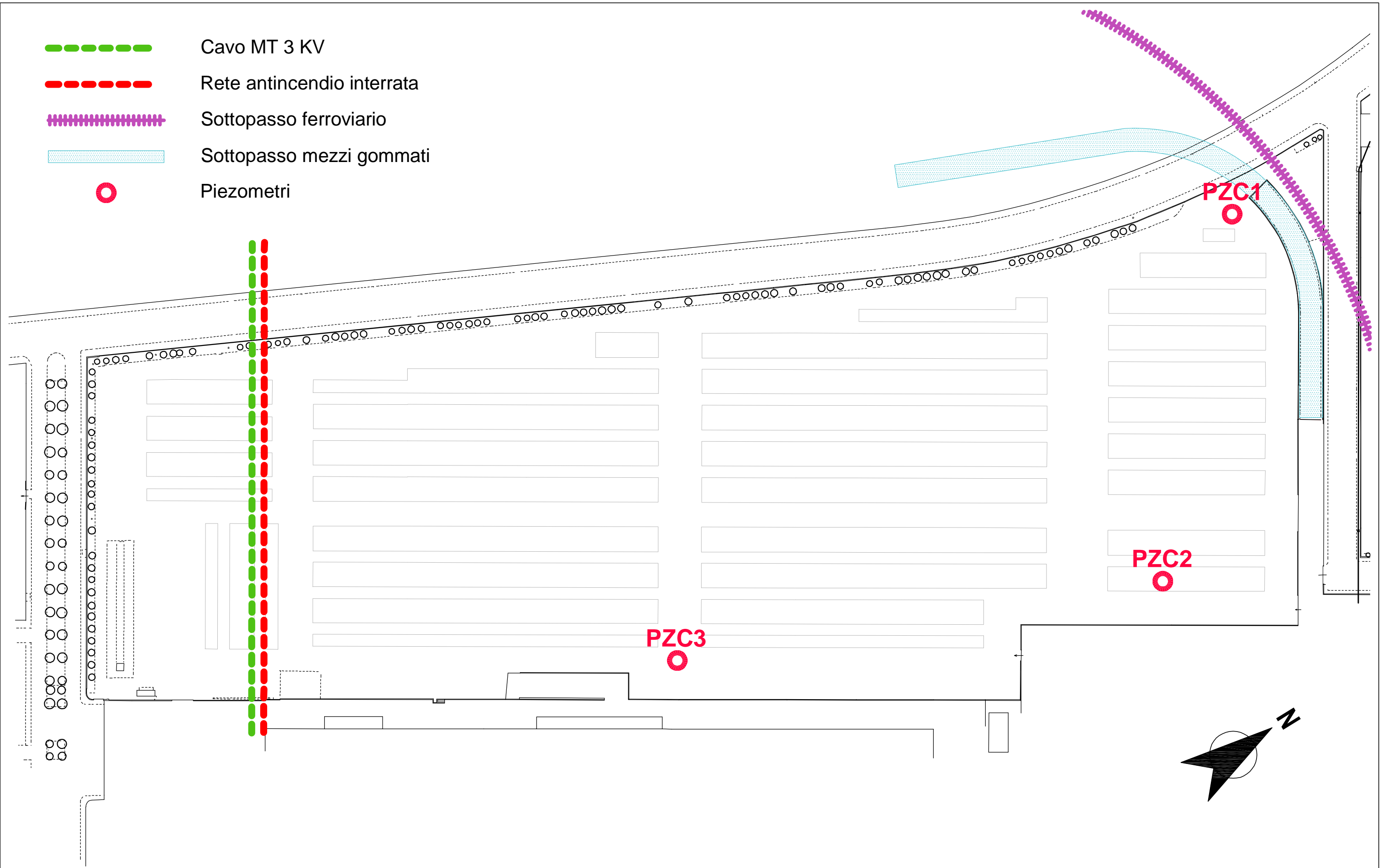



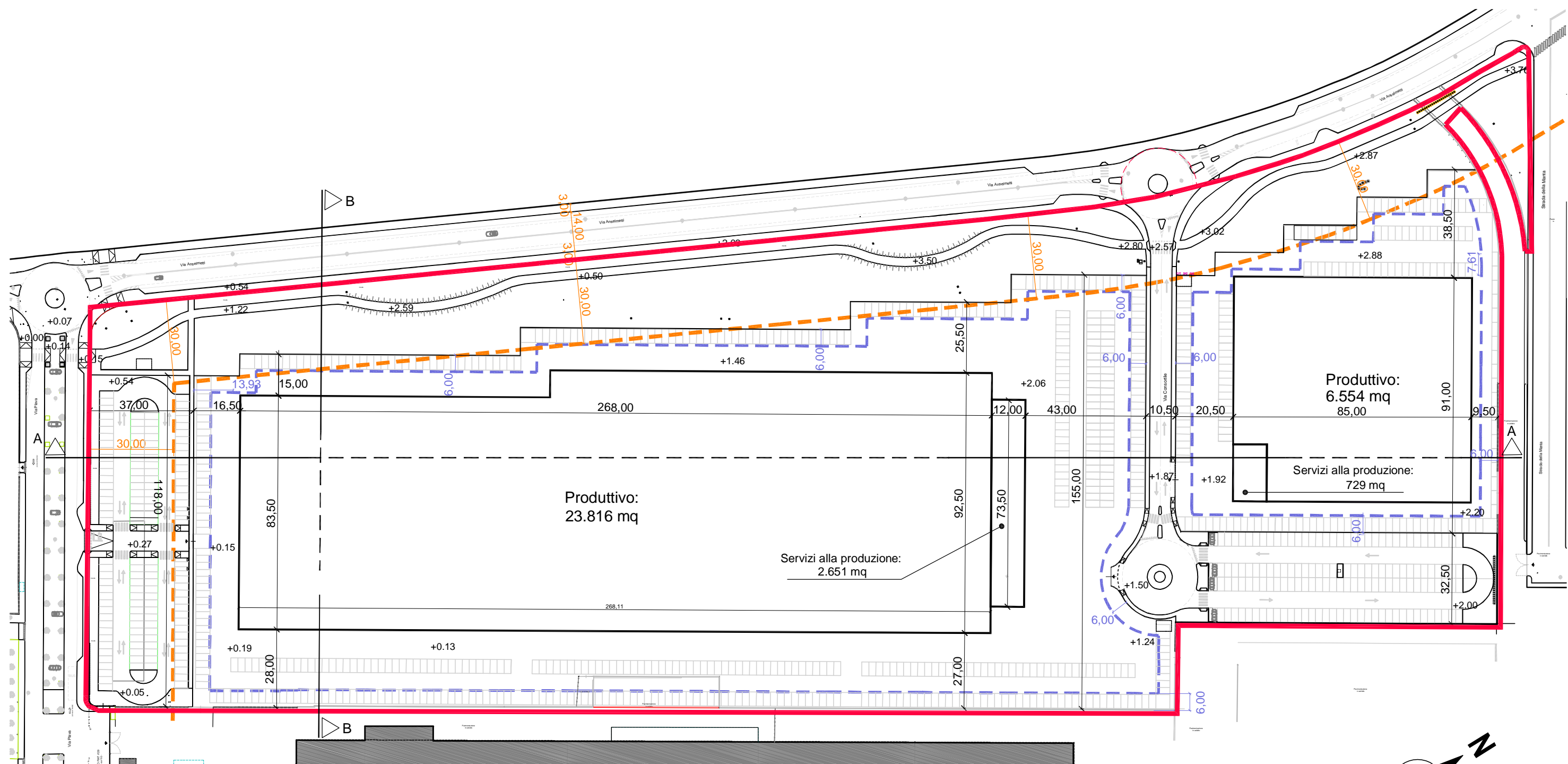

LEGENDA

- Perimetro Area 'Zona C'
- - - Limite fascia di rispetto stradale come da allegato tecnico tav. 7 del P.R.G. vigente (30m)
- - - Distanza dai confini privati (6m - cfr. art. 14 NUEA)

Quota ±0.00 = +254.477 s.l.m.

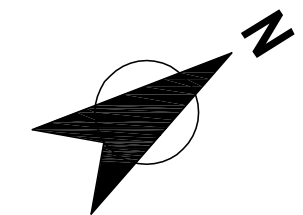



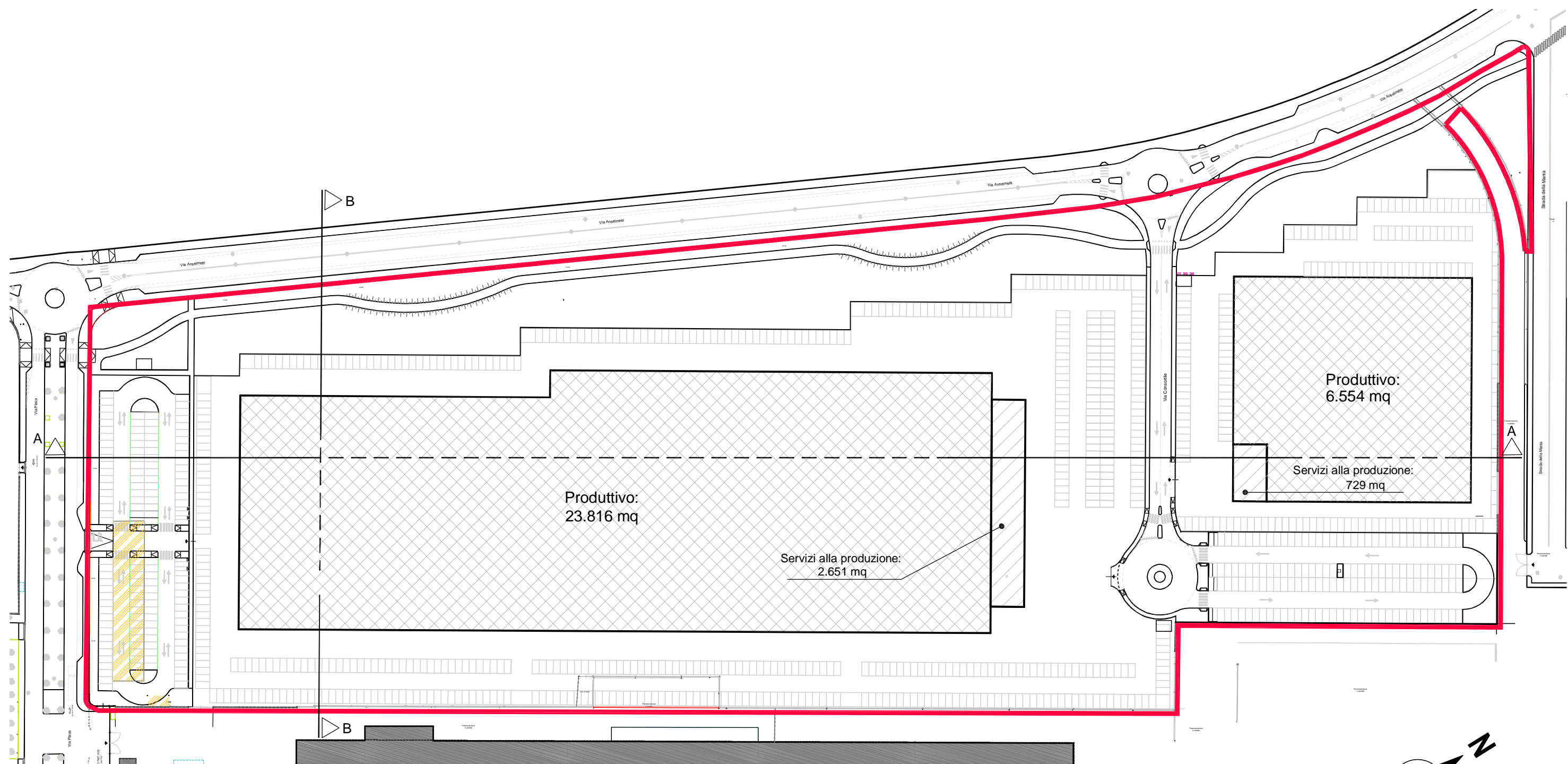

**LEGENDA**

- Perimetro Area 'Zona C'
- Nuova edificazione edifici produttivi (perimetro indicativo)
- Nuova edificazione edifici per servizi alla produzione (perimetro indicativo)
- Demolizioni

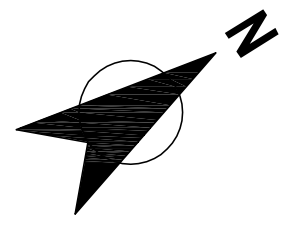



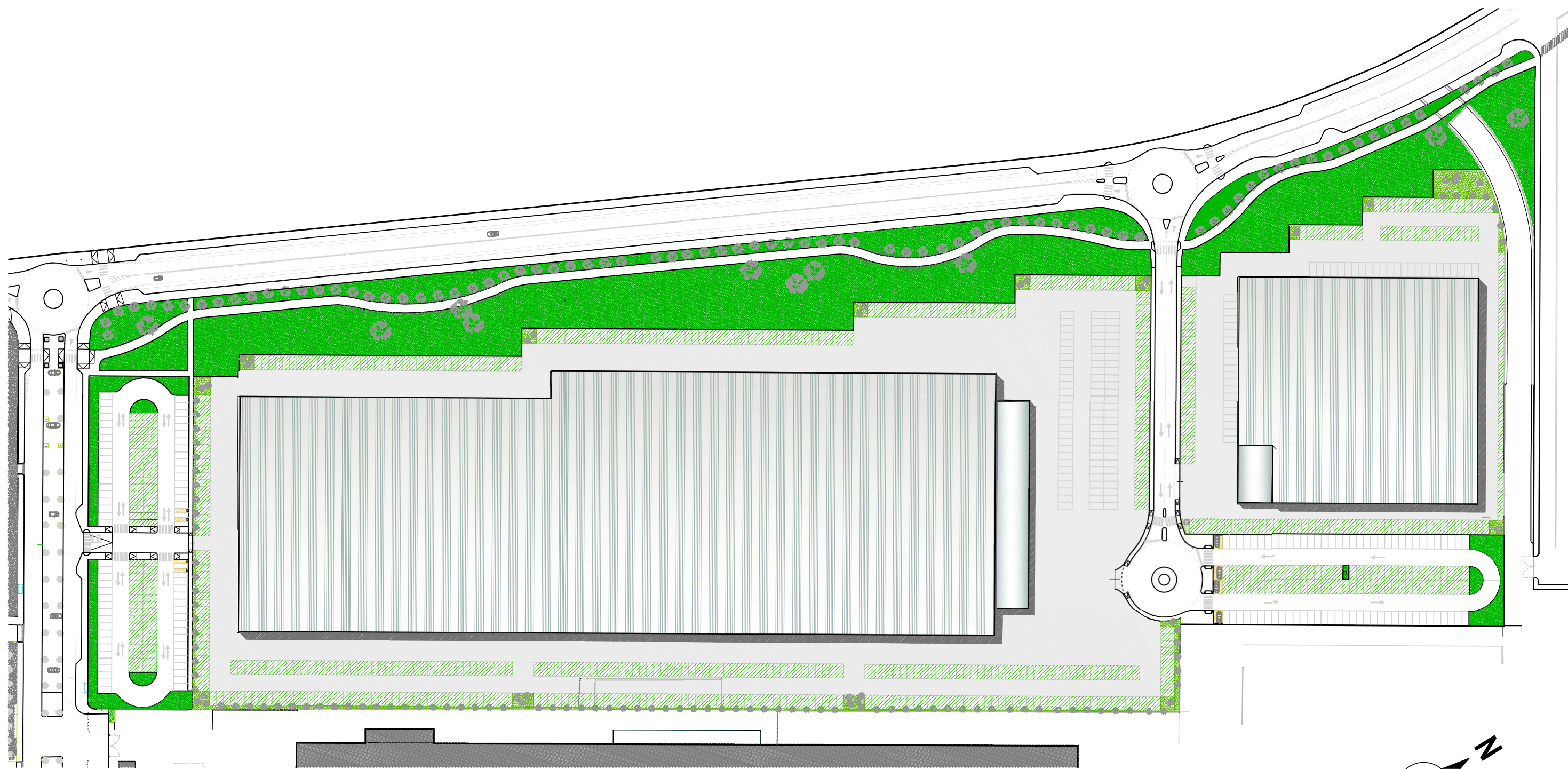







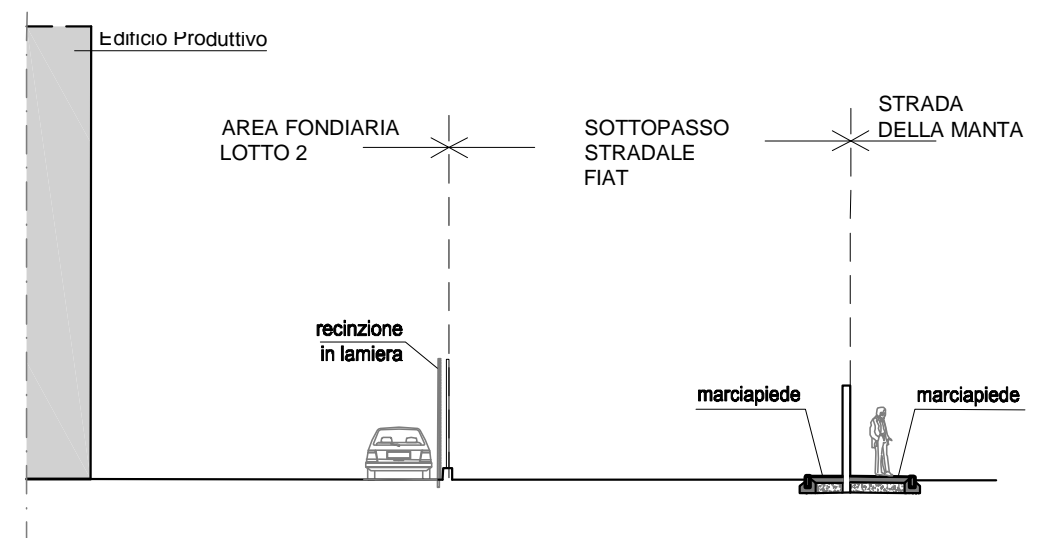
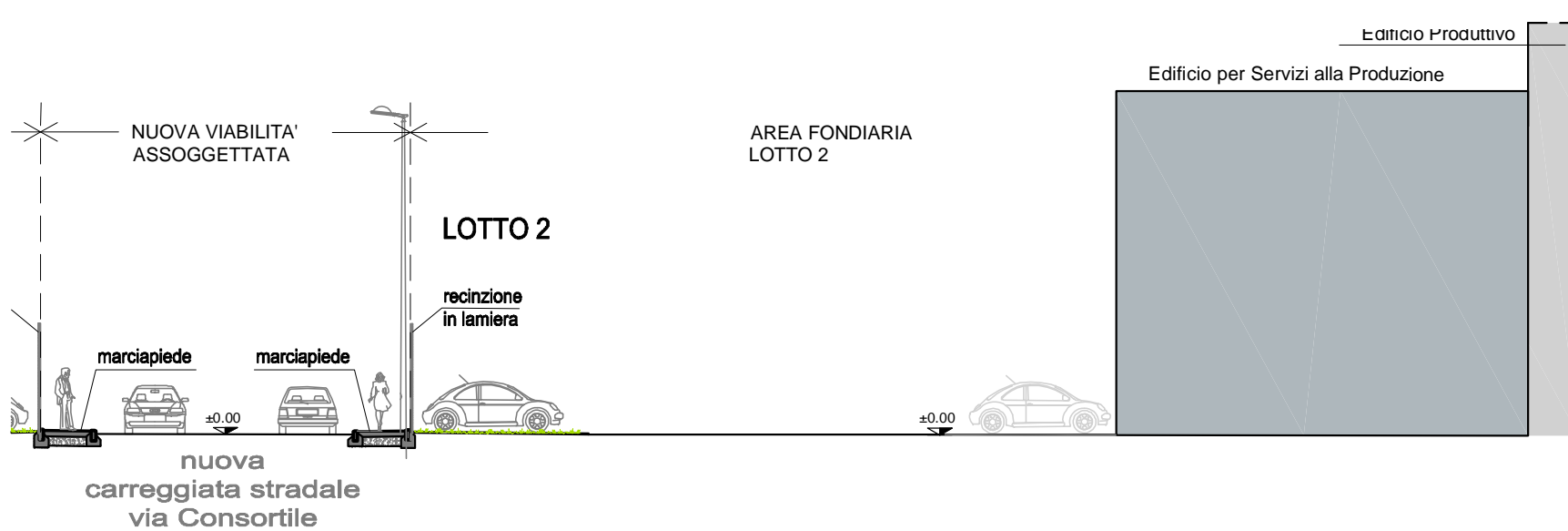
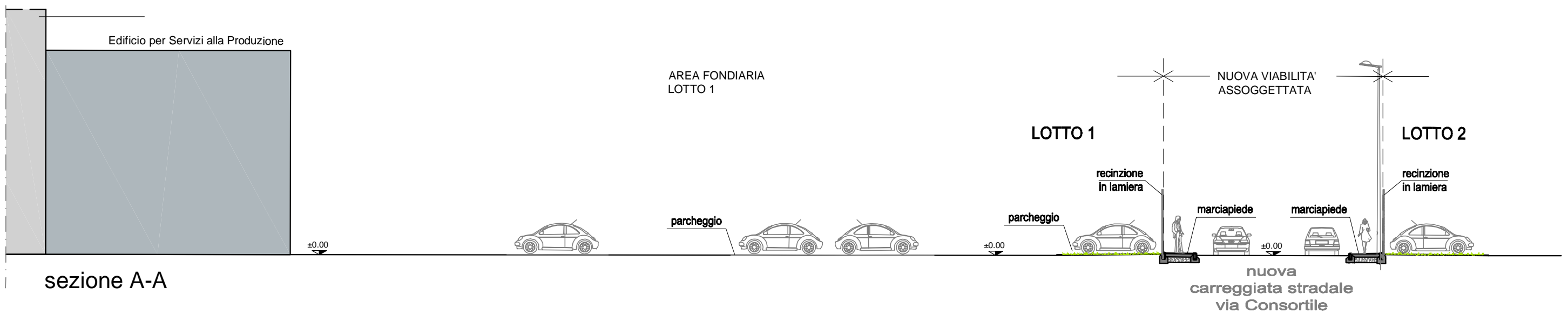
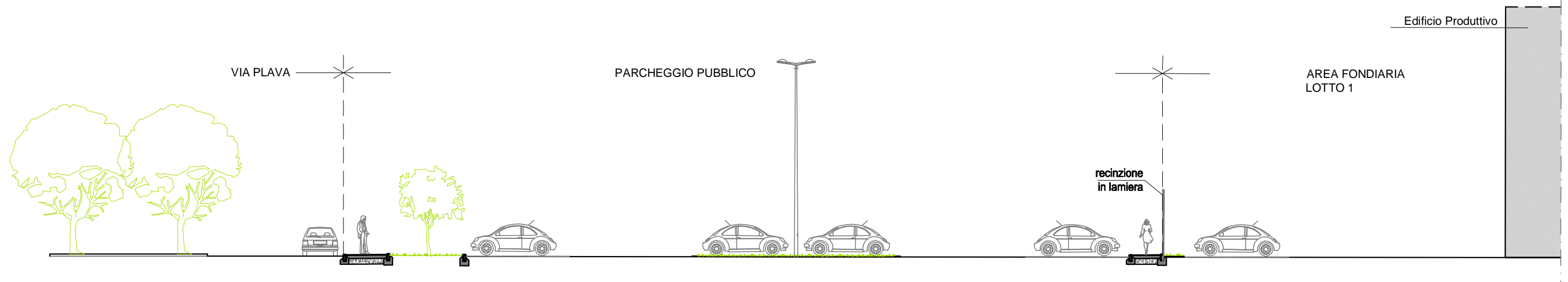

Sezione longitudinale (A-A)

scala 1:200

TAV. 12 a



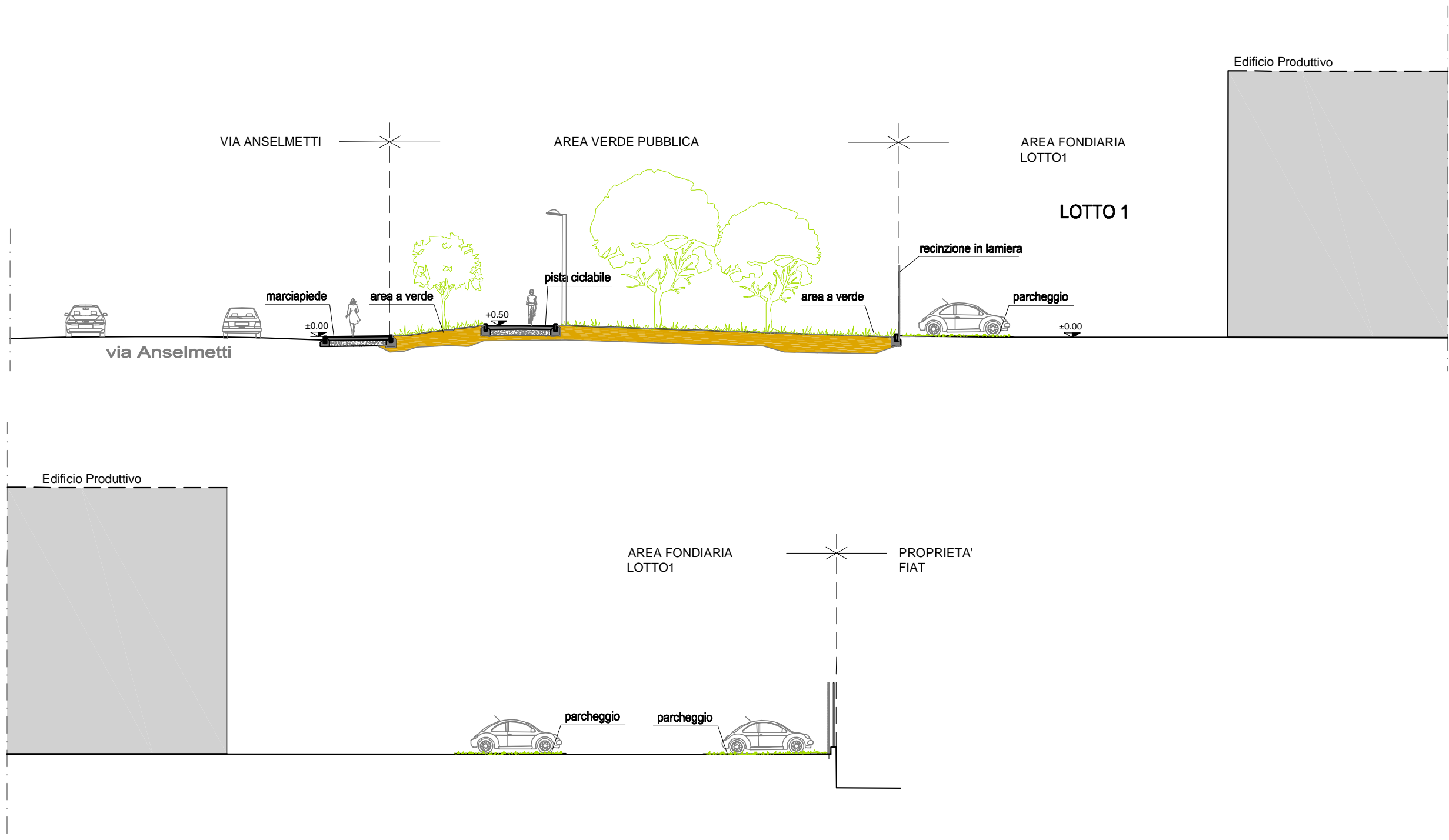

Sezione trasversale (B-B)

scala 1:200

TAV. 12 b