



**CITTÀ DI TORINO**  
**AMBITO 5.10/5 - SPINA 4**  
**GONDRAND - METALLURGICA PIEMONTESE**

**PROGRAMMA INTEGRATO**

LEGGE REGIONALE 9 APRILE 1996 N.18 e s. m. i.

PROPRIETA':

GONDRAND S.p.a.

Via dei Trasporti, 24  
 20090 Vignate (Milano)

METALLURGICA PIEMONTESE S.r.l.

Via Cigna, 169 ang. Via Fossata  
 10155 Torino

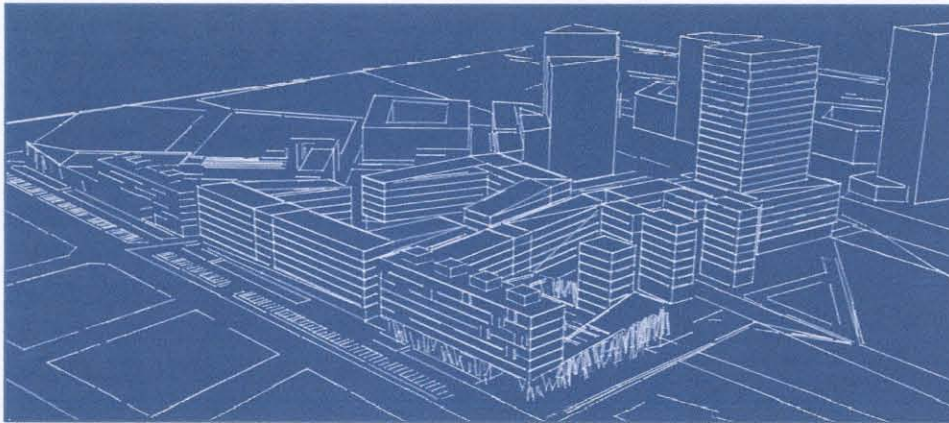

OGGETTO:

Data: 27/07/2009

VISTE PROSPETTICHE

Agg: 27/02/2010

Agg:

PROGETTO:

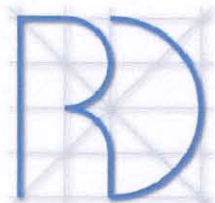

**RDPROGETTO**  
 INGEGNERI ASSOCIATI  
 ING. ROBERTO RUSTICHELLI  
 ING. DOLORES PIERMATTEO  
 VIA GINO LISA 7/a 10020 ARIGNANO  
 TEL. 011.9494559 FAX. 011.9462708  
 e-mail ing@rdprogetto.it



**TAV**  
**08**





VEDUTA GENERALE PR.1/N





VEDUTA GENERALE PR.1N



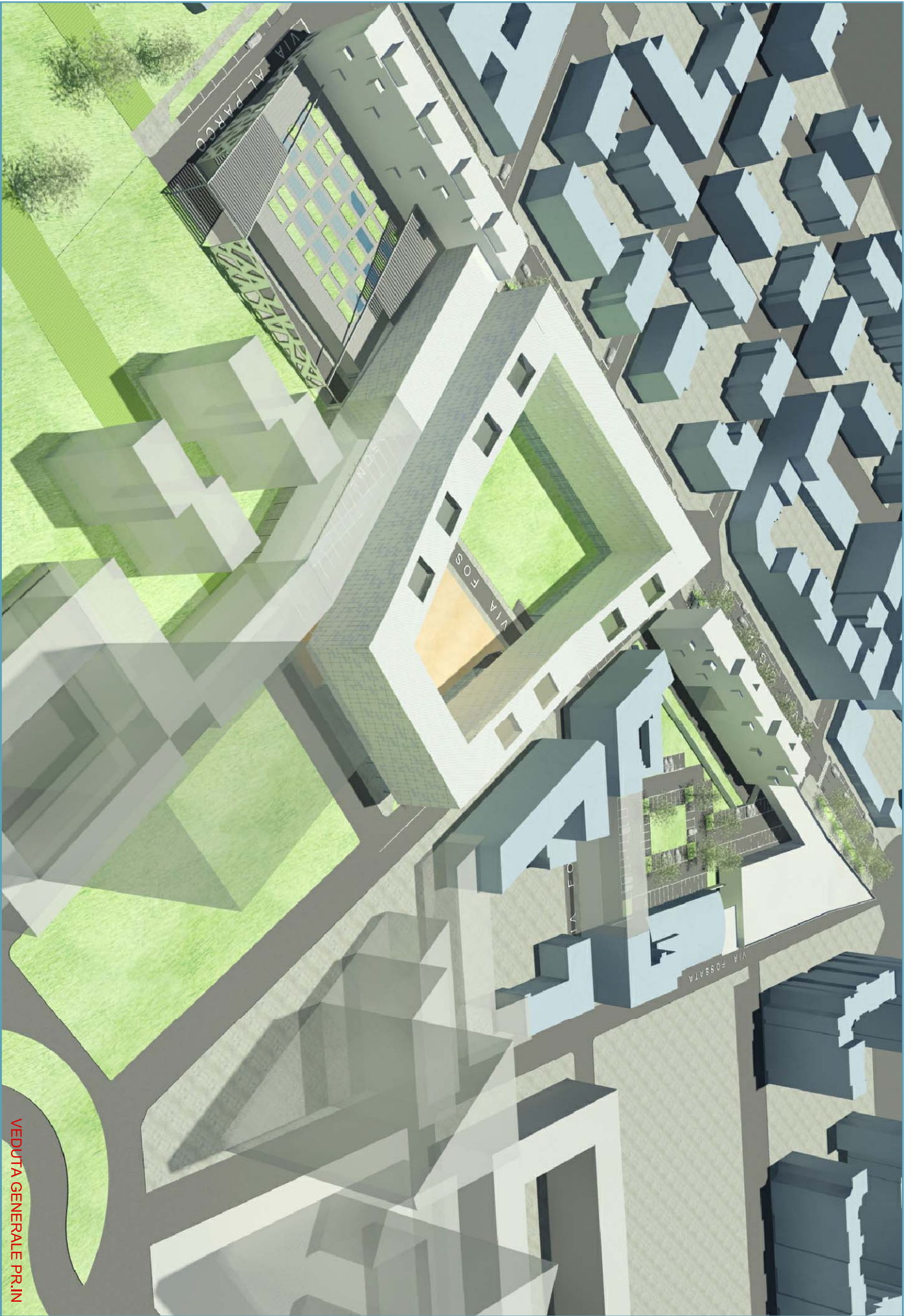

VEDUTA GENERALE PR.1N



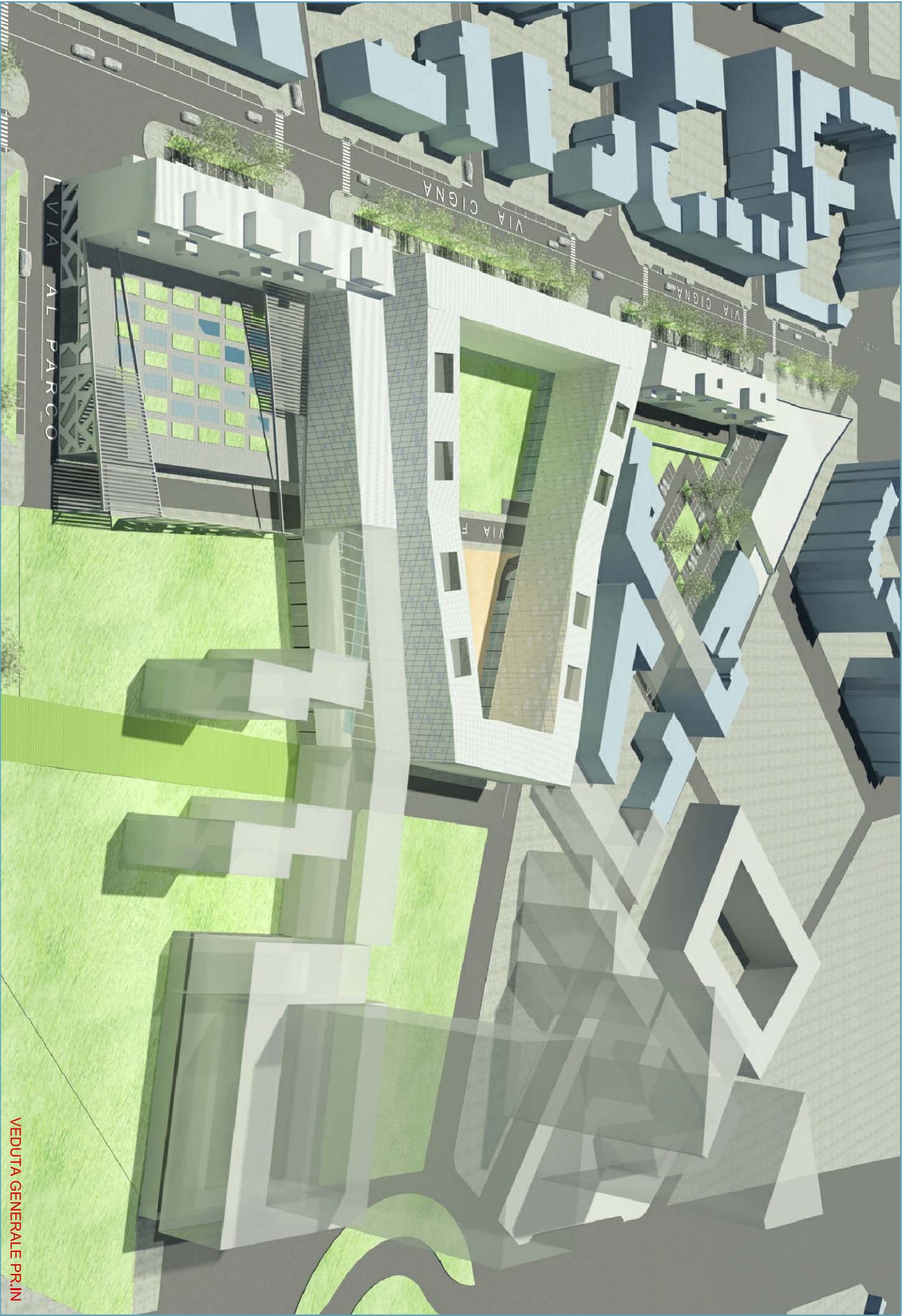

VEDUTA GENERALE PR.1N



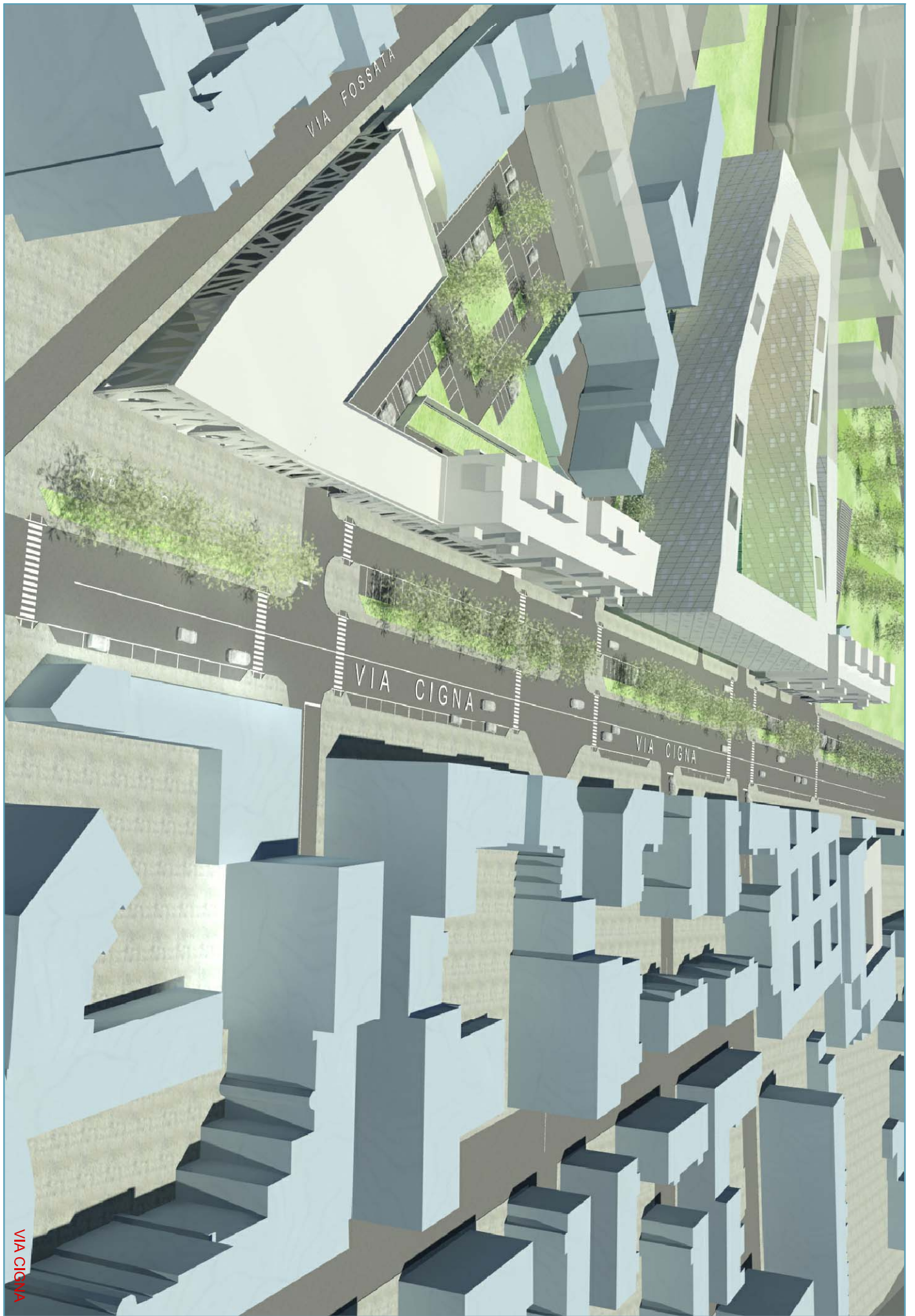

VIA CIGNA

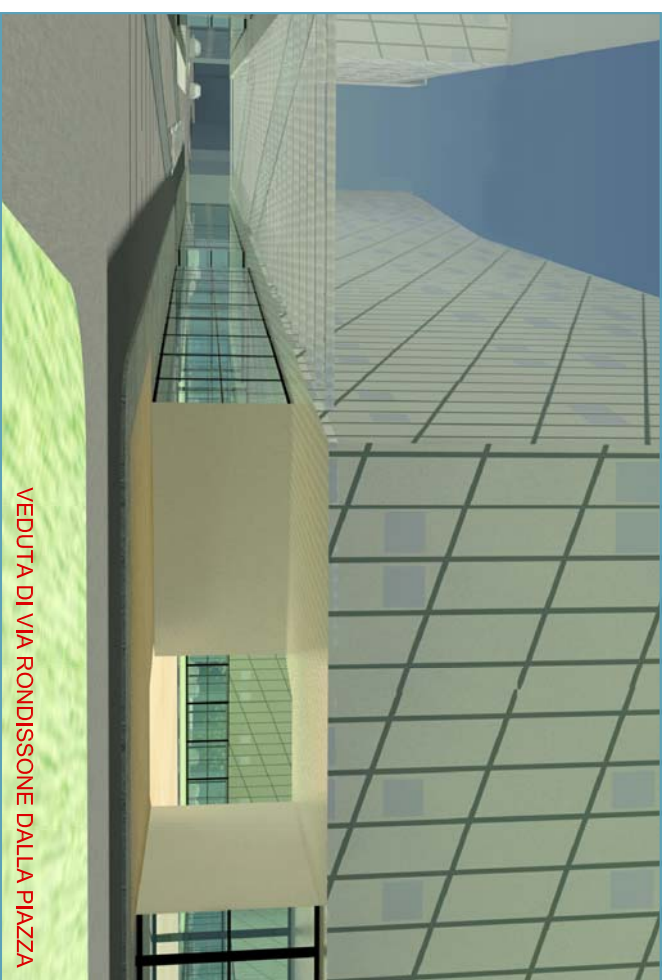
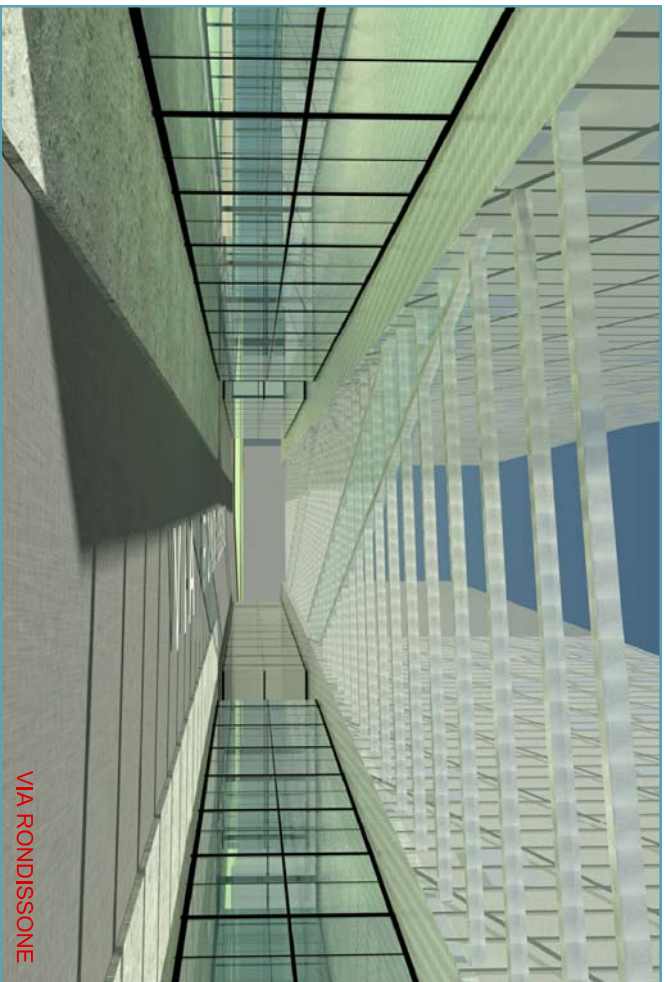





VEDUTA GENERALE PR.1IN



VISTA INTERNO RICOLOCAZIONE CARLINI









PARCHEGGIO INTERNO EDIFICIO COMMERCIALE



INTERNO ISOLATO METALLURGICA PIEMONTESE





VIA CIGNA ANGOLO VIA FOSSATA

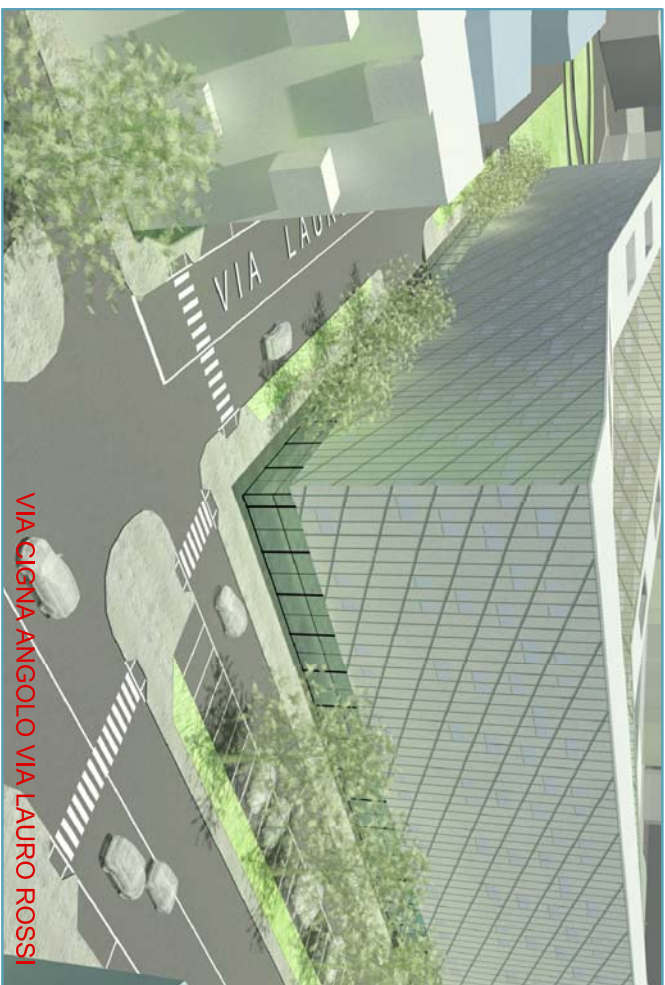

VIA CIGNA ANGOLO VIA LAURO ROSSI



VIA CIGNA ANGOLO VIA RONDISSONE

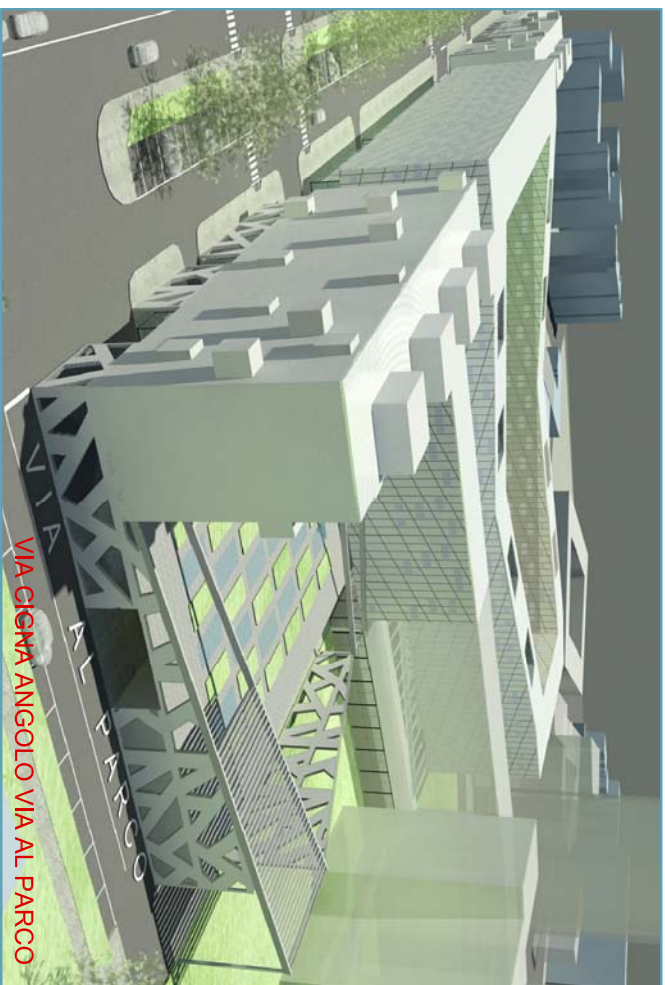

VIA CIGNA ANGOLO VIA AL PARCO



